

## LAUTEX CARRIERS

Material: Steel, Length=3000

PAGE 1/4

### No. 39 PR-CARRIER 45° INSTALLATION

CARRIER No.	PROFILE'S WIDTH	c/c
39C	50	60
39D	60	70
39E	70	80
39F	80	90
39G	90	100
39H	100	110
39J	135	145
39K	140	150
39L	180	190
39M	190	200
39N	280	290
39P	290	300
39X	ACCORDING TO ORDER BUT $\geq 50$ mm	ACCORDING TO ORDER BUT MIN. AIR SPACE 10 mm

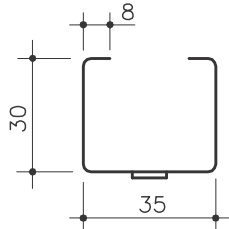

1.0 steel  
0.83 kg/m

### No. 42 H-CARRIER

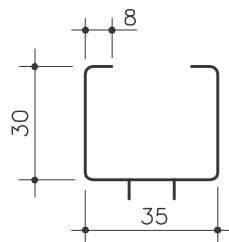

1.0 steel  
0.83 kg/m

### No. 43A UP-CARRIER

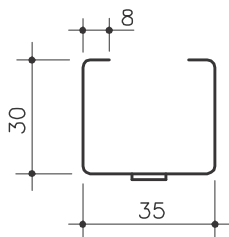

1.0 steel  
0.83 kg/m

### No. 43D UP-CARRIER

FOR UP-300 AND 200/25

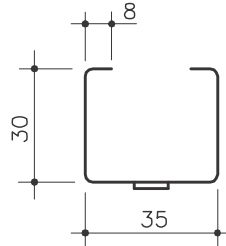

1.0 steel  
0.83 kg/m

### No. 44 PR-CARRIER

CARRIER No.	PROFILE'S WIDTH	c/c
44A	30	40
44B	40	50
44C	50	60
44D	60	70
44E	70	80
44F	80	90
44G	90	100
44H	100	110
44J	135	145
44K	140	150
44L	180	190
44M	190	200
44N	280	290
44P	290	300
44X	ACCORDING TO ORDER	ACCORDING TO ORDER BUT MIN. AIR SPACE 10 mm

### No. 45 K-CARRIER

INSTALLATION WITH AIR SPACE

CARRIER No.	PANEL'S WIDTH	c/c
45A	100	105
45B	100	110
45C	150	155
45D	150	160
45E	200	205
45F	200	210
45G	300	305
45H	300	310
45X	X	X

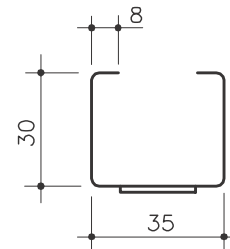

1.0 steel  
0.83 kg/m

### No. 46 K-SEAM CARRIER

CAN BE USED FOR CARRIERS  
No. 45 AND 47

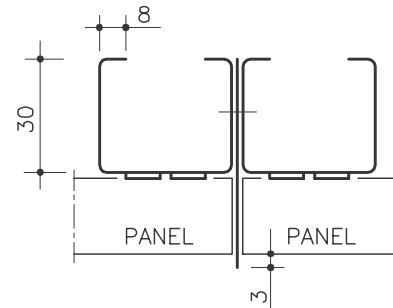

1.0 steel  
2.10 kg/m

### No. 47 STANDARD K-CARRIER

FOR B0/B15 AND  
C-CLASS CEILINGS

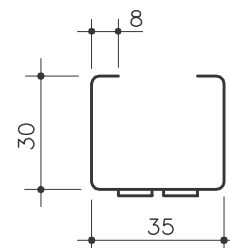

1.0 steel  
0.83 kg/m

## LAUTEX CARRIERS

Material: Steel, Length=3000

PAGE 2/4

**No. 47B K-CARRIER**  
FLANGES OUTWARDS

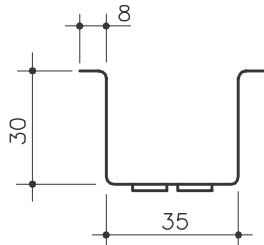

1.0 steel  
0.83 kg/m

**No. 47C BENT K-CARRIER**

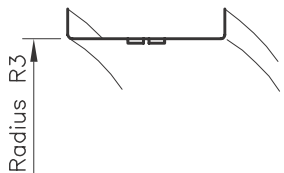
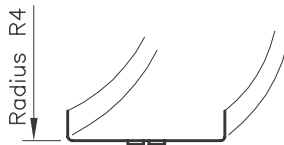

1.0 steel  
0.83 kg/m

**No. 49 K-WALL CARRIER**  
INSTALLATION WITH AIR SPACE

CARRIER No.	PANEL'S WIDTH	c/c
49A	100	105
49B	100	110
49C	150	155
49D	150	160
49E	200	205
49F	200	210
49G	300	305
49H	300	310

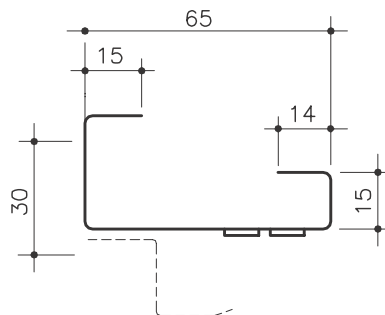

1.0 steel  
1.04 kg/m

**No. 54 SPRING-T-CARRIER**

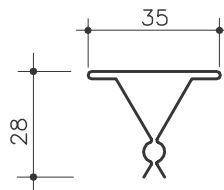

0.5 steel, L=4000  
0.44 kg/m

**No. 55 SUPPORT PROFILE**

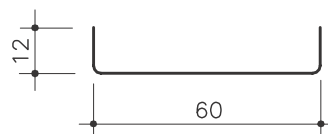

1.5 steel  
0.96 kg/m

**No. 56 SUPPORT TUBE**

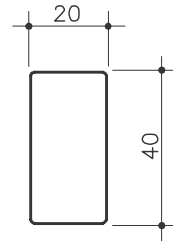

1.5 steel, L=6000, Painted  
1.37 kg/m

**No. 87 BENT K-CARRIER**

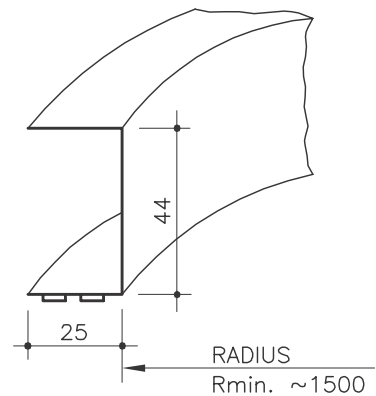

THE WIDTH AND c/c OF THE PANEL CAN BE CHOSEN FREELY

1.0 steel, L=3000  
0.72 kg/m

## LAUTEX CARRIERS

Carriers: Fe, L=3000

PAGE 3/4

### No. 88 BENT PR-CARRIER

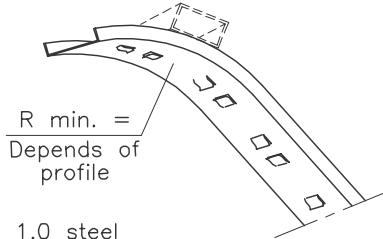
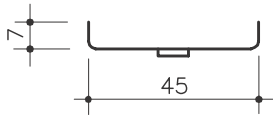

1.0 steel  
0.44 kg/m

CARRIER No.	PROFILE'S WIDTH	c/c
88A	30	40
88B	40	50
88C	50	60
88D	60	70
88E	70	80
88F	80	90
88G	90	100
88H	100	110
88J	135	145
88K	140	150
88L	180	190
88M	190	200
88N	280	290
88P	290	300
88X	ACCORDING TO ORDER	ACCORDING TO ORDER BUT MIN. AIR SPACE 10 mm

### No. 89 BENT PR-CARRIER

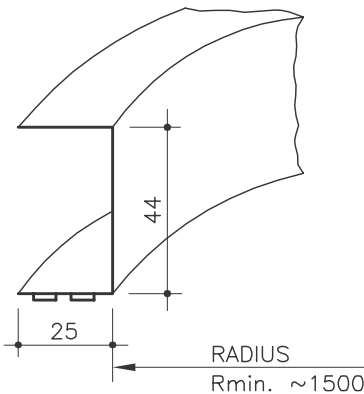

THE WIDTH AND c/c OF THE PROFILE CAN BE CHOSEN FREELY

1.0 steel, L=3000  
0.72 kg/m

### No. 90 SUSPENSION CARRIER

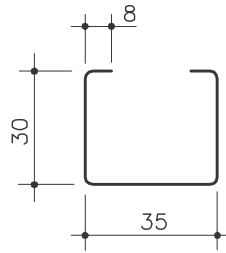

1.0 steel  
0.83 kg/m

### No. 91 UP-CARRIER 45° LEFT INSTALLATION

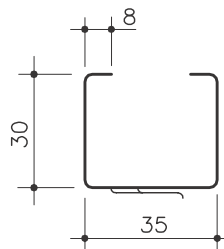

1.0 steel  
0.83 kg/m

### No. 92 UP-CARRIER 45° RIGHT INSTALLATION

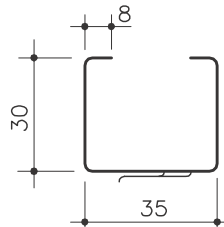

1.0 steel  
0.83 kg/m

### No. 94 NS-CARRIER FOR B0 AND C-CLASS CEILINGS

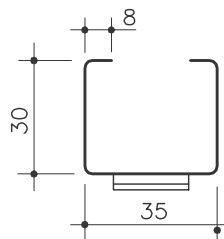

1.0 steel  
0.83 kg/m

### No. 95 HALF SPRING-T-CARRIER

FOR INSTALLATION OF NJ-CASSETTES WITH AIR SPACE

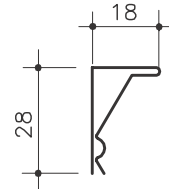

0.6 steel, Length=4000  
0.32 kg/m

### No. 96A UP-WALL CARRIER FOR RIGHT INSTALLATION

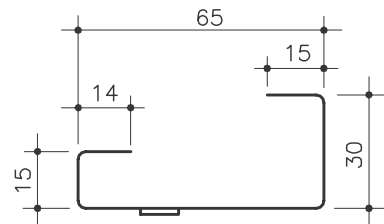

1.0 steel  
1.04 kg/m

### No. 96B UP-WALL CARRIER FOR LEFT INSTALLATION

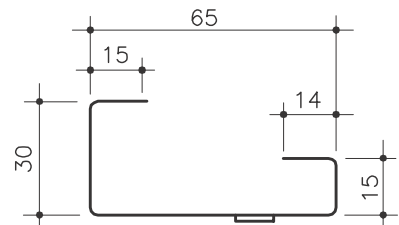

1.0 steel  
1.04 kg/m

## LAUTEX CARRIERS

Carriers: Fe, L=3000

PAGE 4/4

**No. 98 UP-WALL CARRIER FOR BOTH HAND INSTALLATION FOR B0/B15 CEILINGS**

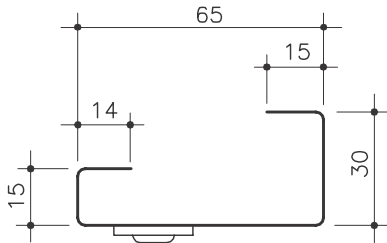

1.0 steel  
1.04 kg/m

**No. 105 PRE-ASSEMBLED HALF SPRING-T-CARRIERS**

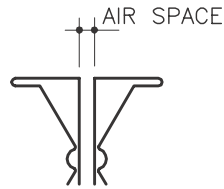

CARRIER No.	AIR SPACE
105A	3 mm
105B	4 mm
105C	5 mm
105D	6 mm
105E	7 mm
105F	8 mm
105H	10 mm
105M	15 mm
105R	20 mm

0.6 steel, Length=4000  
2.76 kg/m

**No. 100 UP-SEAM CARRIER**  
CAN BE USED FOR CARRIER No. 43

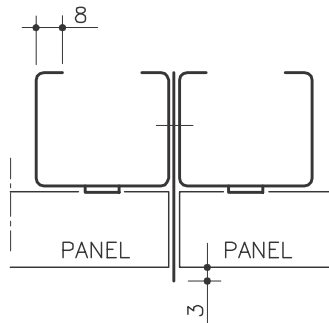

1.0 steel  
2.10 kg/m